

# CHG HORIZONTAL PLATE CLAMPS



## HORIZONTAL PLATE CLAMP

### Industry standard horizontal plate clamps

Working load limit (WLL) 1000 - 10000kgs

The CHG horizontal plate clamps have been specifically designed to be used, in pairs, for the transportation of plate bundles as well as single plates with a minimum thickness of 5mm.

A pair of clamps used with a two legged chain sling are suitable for small plates. It is recommended to use two pairs in conjunction with a spreader beam for handling of larger plates. These units are supplied as standard with a smooth jaw. There is also the option of hardened steel teeth for special applications. Please contact our technical department for further details.

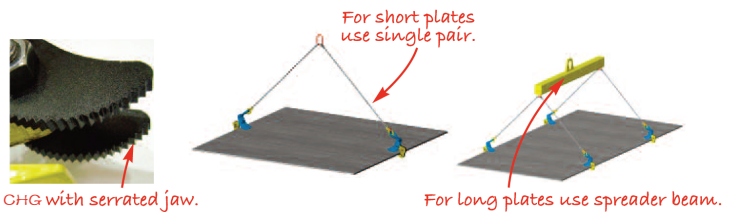

CHG with serrated jaw.

For long plates use spreader beam.

Model	WLL kgs*	Jaw capacity mm	A mm	B mm	C mm	D mm	E mm	F mm	G mm	Weight kgs*
CHG1	1000	5 - 32	15	82	60	100	32	44	13	8
CHG2	2000	5 - 32	30	82	60	100	50	73	18	11
CHG4	4000	5 - 50	40	112	80	100	64	92	25	17
CHG6	6000	5 - 75	55	172	100	130	90	130	35	46
CHG8	8000	5 - 75	55	172	105	130	90	130	35	53
CHG10	10000	5 - 100	65	215	120	150	114	114	35	95

\*Per pair.

\*\*Weight per pair of clamps without chains.



\*Chain slings NOT included.

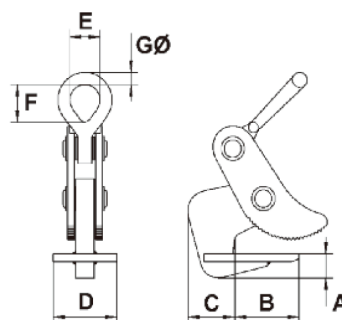

NB: The angle between the chain / rope legs must not exceed 90° (45° from vertical).

NB: These units must NOT be used with endless chain slings.